

| You are in: [Lozier Products](#) > [Products](#) > [S-Series Storage Shelving Back Panels](#)

# S-Series Storage Shelving Back Panels

Part Number: **Part Number: SSBP**



S-Series Back Panel can be used to stabilize S-Series Shelving. Use on back of section to create a closed or "closet" section.

## Product Details:

- 1/8" Hardboard, unfinished
- 108" - 144" Backs are two-pieces joined with a Splicer
- Notched to accept Back-to-Back Connectors
- Can use on back of each section to create a closed or "closet" section
- Back Panels (or Crossbraces) are required on ends of each run and every fourth section in between for stabilization
- See diagram below for minimum recommended placement of Back Panels per run
- Components include Back Panel(s), Screws, Washers and Splicer (ordered separately)

## MINIMUM BRACING REQUIREMENTS DIAGRAM

1	X							
2	X	X						
3	X		X					
4	X			X				
5	X				X			
6	X			X		X		
7	X			X			X	
8	X				X			X
9	X				X			X

X = DENOTES BRACED SECTION

### HOW TO ORDER BACK PANELS

Back Panel component requirements vary by Section Height. See chart below to determine part numbers and quantities needed for each section.

SECTION HEIGHT	36"W SECTION BACK PANEL QTY
36"	1 (SSBP36036)
48"	1 (SSBP36048)
60"	1 (SSBP36060)

72"	1 (SSBP36072)
84"	1 (SSBP36084)
96"	1 (SSBP36096)
108"	1 (SSBP36084) + 1 (SSEBP36024)
120"	1 (SSBP36084) + 1 (SSEBP36036)
144"	1 (SSBP36072) + 1 (SSEBP36072)

Back Panel Standard Finish: N/A (no finish)

## How to Order

---

### S-Series Storage Back Panel Splicer

---

- Splices two-piece storage shelving back panels (108-144H)
- 23 7/8 wide splicer used for both 3' and 4' wide storage sections

### Product Options and Numbers

Part #: **SS1151 XB1**

Splicer: **SS1151**

Standard Finish: **XB1**

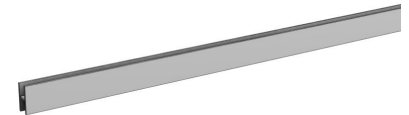

#### Suffix Key

**XB1**

- White Plastic

### S-Series Storage Screw

---

- #8 x 3/4" Phillips head sheet metal screws
- Connect two open S-Series Storage Upright Assemblies through the pilot holes punched in the Upright post face to create a double-entry island
- May also be used to attach Back Panels to Upright Assemblies

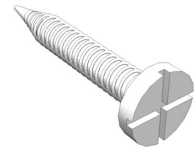

Assembly Height	# of Screws Required to Connect Uprights
36" - 72"	2
84" - 108"	3
120" - 144"	4

## Product Options and Numbers

Part #: **SS2221** N/A

S-Series Back-to-Back Screw: **SS2221**

Standard Finish: **N/A**

### Suffix Key

N/A

- No Finish

## S-Series Storage Shelving Lock Washers

- #8 lock washer, internal/external tooth
- Used for S-Series Storage Shelving assemblies



## Product Options and Numbers

Part #: **SS1511** N/A

S-Series Back-to-Back Screw: **SS1511**

Standard Finish: **N/A**

Suffix Key

N/A

- No Finish