

| You are in: Lozier Products > Products > Widespan Gravity Flow Oil Rack

Widespan Gravity Flow Oil Rack

Part Number:



Product Details:

- Shelving configuration supported by Widespan Uprites 30", 36", or 48" deep
- Utilizes Widespan Low Profile Beams installed offset. Rear beam is installed higher (See chart below with available offsets for respective depth and downslant angle)
- Widespan Low Profile Beams available 48"W or 60"W
- Optional Widespan Dividers and Widespan Gravity Flow Fronts install on shelf wires to separate and contain merchandise

How to Order

- Order Widespan Uprites separately 30", 36", or 48" deep in desired height (two required per individual section run and one additional for add-on sections)
- Order two 48"W or 60"W Widespan or Multifunction Low Profile beams per shelf level. A minimum of two beam levels is required per section. Required beam levels can include a combination of Gravity Flow levels and Flat levels. A beam must be installed within 6" of the floor and maximum spacing between beams is 48".
- Order one Widespan Gravity Wire Shelf for each

Gravity Flow level (See chart offset and respective angle)

- Order one Widespan Flat Wire shelf for each desired flat level
- Order five Low Profile Gravity Supports or five Low Profile Flat Shelf Supports per level
- Order desired number of 3"H Widespan Dividers
- Order desired number of 3"H or 6"H Widespan or Multifunction Gravity Flow Fronts
- Order Widespan Floor Anchor (optional)

System Depth	Offset (Inches)	Downslant Angle (deg.)
30	6	11.5
30	8	15.2
36	6	9.5
36	8	12.7
48	8	9.5
48	10	11.9

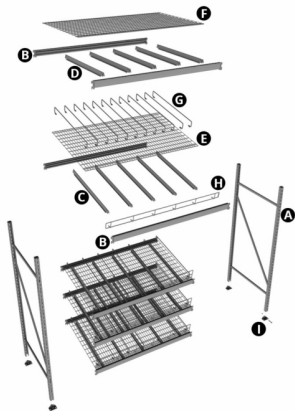

COMPONENTS (ORDER SEPARATELY):

A

- Widespan Upright Frame (30"D, 36"D or 48"D) #WSU_
- B** - Widespan Low Profile Beam (two per shelf level 48"W or 60"W) #WSLB_PK4
- C** - Widespan Gravity Low Profile Shelf Supports #WSGSSL_PK5
- D** - Widespan Flat Level Low Profile Shelf Supports #WSSSL_PK5
- E** - Widespan Gravity Wire Grid Shelf #WSGW_1EA
- F** - Widespan Flat Wire Grid Shelf #WSW_1EA
- G** - Widespan Divider (30"D, 36"D or 48"D) #WSGFD_PK25
- H** - Widespan Gravity Flow Front (3"H or 6"H) #WSGFF_Pk6
- I** - Widespan Floor Anchor (optional) #WS1241

Widespan Upright Frame (One-Piece 48"H - 120"H)

- One-piece Upright Frames for units 48" - 120"
- Upright post slotted on face, allows shelf adjustment 2" on center
- Square holes punched on sides of Upright post for accessories
- Accessory holes punched 6" on center on face of Upright also aid beam placement
- Top Caps included on each Upright
- One Frame required for each section, plus one at end of each run
- To provide increased protection under harsh shipping conditions add "SPC" to part number for additional packaging
- Floor Anchors, Floor Protectors, or Back to Back Connectors may be ordered separately
- Evenly distributed load of 10,000 lbs per Upright Frame at 48" max. Beam spacing, vertically



REINFORCED UPRIGHT FRAME

- "RE" Frame available in 72" - 120"H and all depths (lower Frame only on 132" - 192")
- For use with hand loader/stacker
- Reduces chance of Frame damage
- Channel welded inside each post in lower 48"
- Welded foot plate for anchoring, 1/2" hole



Product Options and Numbers

Example Part #: **WSU 18 048 RE SPC PLT**

Widespan Uprite : **WSU**

Depth: **18"**, 24", 30", 36", 42", 48"

Height: **048"**, 060", 072", 084", 096", 120"

Reinforced Uprite for Hand Loader/ Stacker Applications: **RE**, Leave blank if not applicable

Additional Packaging: **SPC**, Leave blank if not applicable

Standard Finish: **PLT**, Optional Catalog Colors

Suffix Key

PLT

-Platinum

Widespan/Multi-Function Low Profile Gravity Flow/Flat Beam

- Available Widespan or Multi-Function style
- 2 1/2H profile
- Accepts gravity flow or flat shelf supports/shelves
- 600lb capacity
- Same beam used for flat or gravity flow application

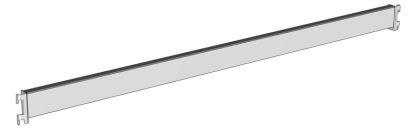

Product Options and Numbers

Example Part #: **WS LB 48 PK4 PLT**

Beam Type: **WS (Widespan)**, MF (Multi-Function)

Low Profile Beam: **LB**

Beam Width: **48"**, 60"

Unit of Measure: **PK4**

Standard Finish: **PLT**, Optional Catalog Colors

Suffix Key	
PLT	- Platinum
PK4	- 4-Pack

Widespan Low Profile Shelf Support

- Available Flat or Gravity Feed
- Five (5) required per beam level



Product Options and Numbers

Example Part #: **WS G SS L 30 6 PK5 PLT**

System: **WS (Widespan)**

Flat or Gravity: Omit (Flat), **G (gravity)**

Shelf Support: SS

Low Profile: L

Widespan Depth: 30", 36", 48"

Beam Offset: 6 or 8 (30D), 6 or 8 (36D), 8 or 10 (48D), Omit for Flat

Unit of Measure: PK5

Standard Finish: PLT, Optional Catalog Colors

Suffix Key	
PLT	- Platinum
PK5	- 5-Pack

Widespan/Multi-Function Gravity/Flat Wire Shelf

- Available Widespan or Multifunction style
- Available Flat or Gravity Feed

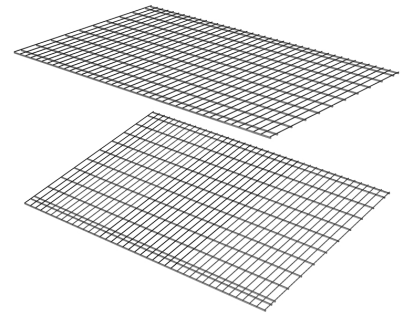

Product Options and Numbers

Example Part #: **WS GW 30 48 1EA**

Beam Type: WS (Widespan), MF (Multi-Function) style

Flat or Gravity: W (flat), GW (gravity)

Widespan Depth: 30", 36", 48"

Section Width: 48", 60"

Grid Spacing: 1"

Unit of Measure: EA

Standard Finish: PLT, Optional Catalog Colors

>

Suffix Key	
PLT	- Platinum

EA

- Each

Widespan Dividers

- Creates lanes for Gravity Flow wire shelf levels
- Tension attachment to Gravity Wire Shelf
- 3" High

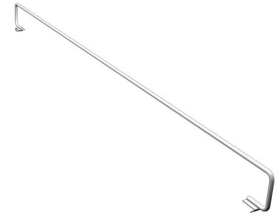

Product Options and Numbers

Example Part #: **WSGFD 48 PK25 PLT**

Widespan Gravity Feed Divider: **WSGFD**

Widespan Depth: 30", 36", **48"**

Unit of Measure: **PK25**

Standard Finish: **PLT**, Optional Catalog Colors

Suffix Key	
PK25	- 25 Pack
PLT	- Platinum

Widespan/Multi-Function Gravity Flow Fronts

- Provides product stop for Gravity Feed
- 3" and 6" heights
- Select Front size taller than displayed product's center of gravity

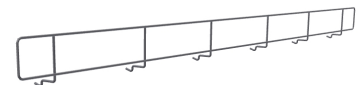

Product Options and Numbers

Example Part #: **WSGFF 5 3 PK6 PLT**

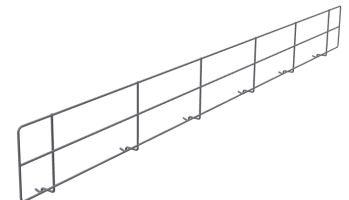

System: **WS (Widespan)**, MF (Multi-Function)

Gravity Feed Front: **GFF**

Section Width: 4', **5'**

Front Height: **3"**, 6"

Unit of Measure: **PK6**

Standard Finish: **PLT**, Optional Catalog Colors

Suffix Key

PLT	- Platinum
PK6	- 6 Pack

Widespan Floor Anchor

- Heavy gauge steel angle fastens Uprite Frame to floor
- Required when height-to-depth ratio exceeds 6 to 1
- Use as required to meet seismic anchoring specifications
- Uprite mounting hardware included
- Anchor bolt not included

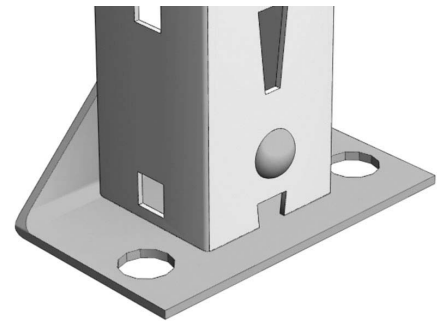

Product Options and Numbers

Example Part #: **WS1241 GLV**

Widespan Floor Anchor: **WS1241**

Standard Finish: **GLV**

Suffix Key

GLV	- Galvanized
------------	--------------